

## [September-2022Braindump2go Free AI-900 Dumps PDF Download[Q149-Q160

September/2022 Latest Braindump2go AI-900 Exam Dumps with PDF and VCE Free Updated Today! Following are some new Braindump2go AI-900 Real Exam Questions!QUESTION 149When you design an AI system to assess whether loans should be approved, the factors used to make the decision should be explainable.This is an example of which Microsoft guiding principle for responsible AI?A. transparencyB. inclusivenessC. fairnessD. privacy and securityAnswer: AExplanation: Achieving transparency helps the team to understand the data and algorithms used to train the model, what transformation logic was applied to the data, the final model generated, and its associated assets. This information offers insights about how the model was created, which allows it to be reproduced in a transparent way.Reference:

<https://docs.microsoft.com/en-us/azure/cloud-adoption-framework/innovate/best-practices/trusted-ai>

<https://docs.microsoft.com/en-us/azure/cloud-adoption-framework/strategy/responsible-ai>QUESTION 150You are building a tool

that will process images from retail stores and identify the products of competitors.The solution will use a custom model.Which Azure Cognitive Services service should you use?A. Custom VisionB. Form RecognizerC. FaceD. Computer VisionAnswer: AExplanation: Azure Custom Vision is an image recognition service that lets you build, deploy, and improve your own image identifier models. An image identifier applies labels (which represent classifications or objects) to images, according to their detected visual characteristics. Unlike the Computer Vision service, Custom Vision allows you to specify your own labels and train custom models to detect them.QUESTION 151Hotspot QuestionFor each of the following statements, select Yes if the statement is true. Otherwise, select No.NOTE: Each correct selection is worth one point. **Answer Area**

Statements	Yes	No
Organizing documents into groups based on similarities of the text contained in the documents is an example of clustering.	<input type="radio"/>	<input type="radio"/>
Grouping similar patients based on symptoms and diagnostic test results is an example of clustering.	<input type="radio"/>	<input type="radio"/>
Predicting whether a person will develop mild, moderate, or severe allergy symptoms based on pollen count is an example of clustering.	<input type="radio"/>	<input type="radio"/>

Answer: **Answer Area**

Statements	Yes	No
Organizing documents into groups based on similarities of the text contained in the documents is an example of clustering.	<input checked="" type="radio"/>	<input type="radio"/>
Grouping similar patients based on symptoms and diagnostic test results is an example of clustering.	<input checked="" type="radio"/>	<input type="radio"/>
Predicting whether a person will develop mild, moderate, or severe allergy symptoms based on pollen count is an example of clustering.	<input type="radio"/>	<input checked="" type="radio"/>

Explanation: Clustering is a machine learning task that is used to group instances of data into clusters that contain similar characteristics. Clustering can also be used to identify relationships in a datasetRegression is a machine learning task that is used to predict the value of the label from a set of related features.Reference:

<https://docs.microsoft.com/en-us/dotnet/machine-learning/resources/tasks>QUESTION 152Hotspot QuestionFor each of the

following statements, select Yes if the statement is true. Otherwise, select No.NOTE: Each correct selection is worth one point. **Answer Area**

A validation set  
to train the model.  
A validation set  
predicts labels.  
A validation set  
used to train the

Answer:

Statements	Yes	No
A validation set includes the set of input examples that will be used to train the model.	<input type="radio"/>	<input checked="" type="radio"/>
A validation set can be used to determine how well a model predicts labels.	<input checked="" type="radio"/>	<input type="radio"/>
A validation set can be used to verify that all the training data was used to train the model.	<input type="radio"/>	<input checked="" type="radio"/>

Explanation:Box 1: NoThe validation dataset is different from the test dataset that is held back from the training of the model.Box 2: YesA validation dataset is a sample of data that is used to give an estimate of model skill while tuning model's hyperparameters. Box 3: NoThe Test Dataset, not the validation set, used for this. The Test Dataset is a sample of data used to provide an unbiased evaluation of a final model fit on the training dataset.Reference:

<https://machinelearningmastery.com/difference-test-validation-datasets/>QUESTION 153What are two metrics that you can use to evaluate a regression model? Each correct answer presents a complete solution.NOTE: Each correct selection is worth one point.A. coefficient of determination (R<sup>2</sup>)B. F1 scoreC. root mean squared error (RMSE)D. area under curve (AUC)E. balanced accuracyAnswer: Explanation:A: R-squared (R<sup>2</sup>), or Coefficient of determination represents the predictive power of the model as a value between -inf and 1.00. 1.00 means there is a perfect fit, and the fit can be arbitrarily poor so the scores can be negative.C: RMS-loss or Root Mean Squared Error (RMSE) (also called Root Mean Square Deviation, RMSD), measures the difference between values predicted by a model and the values observed from the environment that is being modeled.Incorrect Answers:B: F1 score also known as balanced F-score or F-measure is used to evaluate a classification model.D: aucROC or area under the curve (AUC) is used to evaluate a classification model.Reference:

<https://docs.microsoft.com/en-us/dotnet/machine-learning/resources/metrics>QUESTION 154Drag and Drop QuestionYou need to use Azure Machine Learning designer to build a model that will predict automobile prices.Which type of modules should you use to complete the model? To answer, drag the appropriate modules to the correct locations. Each module may be used once, more than once, or not at all. You may need to drag the split bar between panes or scroll to view content.NOTE: Each correct selection is worth one point.

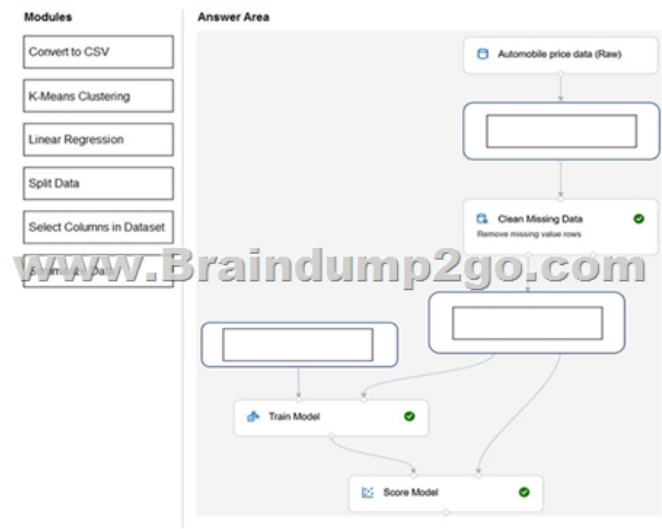

Answer:

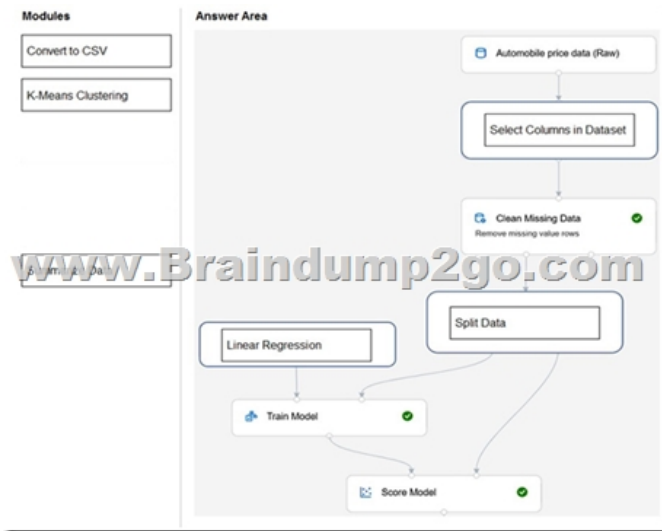

Explanation: Box 1: Select Columns in Dataset For Columns to be cleaned, choose the columns that contain the missing values you want to change. You can choose multiple columns, but you must use the same replacement method in all selected columns. Example:

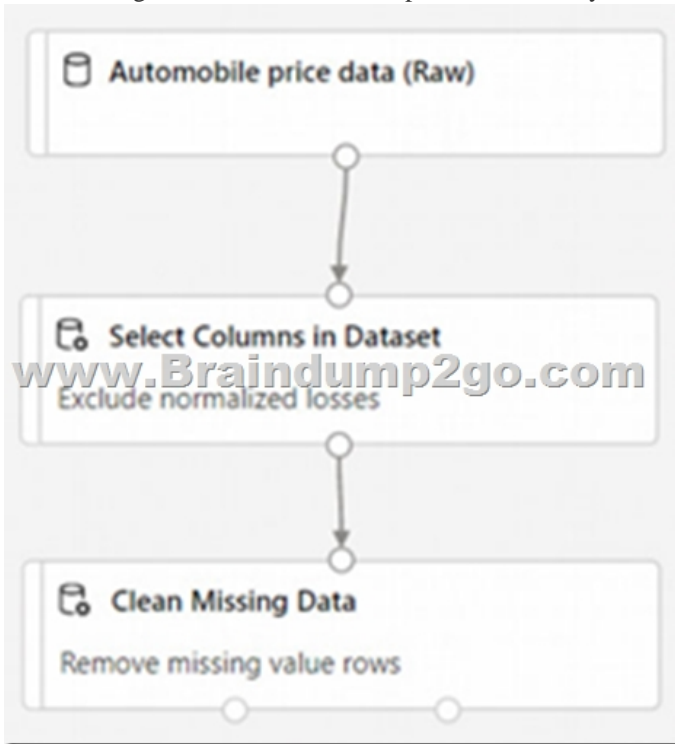

Box 2: Split data Splitting data is a common task in machine learning. You will split your data into two separate datasets. One dataset will train the model and the other will test how well the model performed. Box 3: Linear regression Because you want to predict price, which is a number, you can use a regression algorithm. For this example, you use a linear regression model. Reference: <https://docs.microsoft.com/en-us/azure/machine-learning/tutorial-designer-automobile-price-train-score> QUESTION 155 Which type of machine learning should you use to identify groups of people who have similar purchasing habits? A. classification B. regression C. clustering Answer: C Explanation: Clustering is a machine learning task that is used to group instances of data into clusters that contain similar characteristics. Clustering can also be used to identify relationships in a dataset Reference: <https://docs.microsoft.com/en-us/dotnet/machine-learning/resources/tasks> QUESTION 156 Hotspot Question To complete the sentence, select the appropriate option in the answer area.

Answer Area

\_\_\_\_\_ models can be used to predict the sale price of auctioned items.

- Classification
- Clustering
- Regression

Answer: **Answer Area**

Models can be used to predict the sale price of auctioned items.

Classification  
 Clustering  
 Regression

Explanation: Regression is a machine learning task that is used to predict the value of the label from a set of related features.  
 Reference: <https://docs.microsoft.com/en-us/dotnet/machine-learning/resources/tasks> QUESTION 157 Hotspot Question You have an Azure Machine Learning model that predicts product quality. The model has a training dataset that contains 50,000 records. A sample of the data is shown in the following table.

Date	Time	Mass (kg)	Temperature (C)	Quality Test
26/02/2021	15:31:07	2.108	62.5	Pass
26/02/2021	19:51:59	2.099	62.4	Pass
26/02/2021	02:32:21	2.098	66.4	Fail

For each of the following statements, select Yes if the statement is true. Otherwise, select No. NOTE: Each correct selection is worth one point.

**Answer Area**

Statements	Yes	No
Mass (kg) is a feature.	<input type="checkbox"/>	<input type="checkbox"/>
Quality Test is a label.	<input type="checkbox"/>	<input type="checkbox"/>
Temperature (C) is a label.	<input type="checkbox"/>	<input type="checkbox"/>

Answer: **Answer Area**

Statements	Yes	No
Mass (kg) is a feature.	<input checked="" type="checkbox"/>	<input type="checkbox"/>
Quality Test is a label.	<input checked="" type="checkbox"/>	<input type="checkbox"/>
Temperature (C) is a label.	<input type="checkbox"/>	<input checked="" type="checkbox"/>

Explanation: <https://docs.microsoft.com/en-us/azure/machine-learning/component-reference/filter-based-feature-selection> QUESTION 158 Which two actions are performed during the data ingestion and data preparation stage of an Azure Machine Learning process? Each correct answer presents part of the solution. NOTE: Each correct selection is worth one point. A. Calculate the accuracy of the model. B. Score test data by using the model. C. Combine multiple datasets. D. Use the model for real-time predictions. E. Remove records that have missing values. Answer: CE Explanation:

<https://docs.microsoft.com/en-us/azure/machine-learning/concept-data-ingestion>  
<https://docs.microsoft.com/en-us/azure/architecture/data-science-process/prepare-data> QUESTION 159 You need to predict the animal population of an area. Which Azure Machine Learning type should you use? A. regression B. clustering C. classification Answer: A Explanation: Regression is a supervised machine learning technique used to predict numeric values.

Reference: <https://docs.microsoft.com/en-us/learn/modules/create-regression-model-azure-machine-learning-designer/1-introduction> QUESTION 160 Which two languages can you use to write custom code for Azure Machine Learning designer? Each correct answer presents a complete solution. NOTE: Each correct selection is worth one point. A. Python B. RC. C# D. Scala Answer: AB Explanation: Use Azure Machine Learning designer for customizing using Python and R code. Reference:

<https://azure.microsoft.com/en-us/services/machine-learning/designer/#features> Resources From: 1. 2022 Latest Braindump2go AI-900 Exam Dumps (PDF & VCE) Free Share: <https://www.braindump2go.com/ai-900.html> 2. 2022 Latest Braindump2go AI-900 PDF and AI-900 VCE Dumps Free Share: [https://drive.google.com/drive/folders/1VMADE4rTtp2SjgbY\\_rnCokxgjUS7cH28?usp=sharing](https://drive.google.com/drive/folders/1VMADE4rTtp2SjgbY_rnCokxgjUS7cH28?usp=sharing) 3. 2021 Free Braindump2go AI-900 Exam Questions Download: [https://www.braindump2go.com/free-online-pdf/AI-900-PDF-Dumps\(149-160\).pdf](https://www.braindump2go.com/free-online-pdf/AI-900-PDF-Dumps(149-160).pdf) Free Resources from

Braindump2go, We Devoted to Helping You 100% Pass All Exams!